

Ranger Tugs R-31

Trailerable Command Bridge



Introductory Price \$279,937
Comfortably Equipped

- ◆ Flybridge with dual station electronic controls
- ◆ Pilot House door at helm for easy access to the bow
- ◆ Bow and stern thruster for easy maneuverability
- ◆ Two staterooms, with dinette, sleeps six
- ◆ Forward stateroom with an island berth, en suite head and shower
- ◆ Midship stateroom with double berth and day head
- ◆ 15+ knot cruise speed
- ◆ Trailerable (Flybridge retracts for trailering)

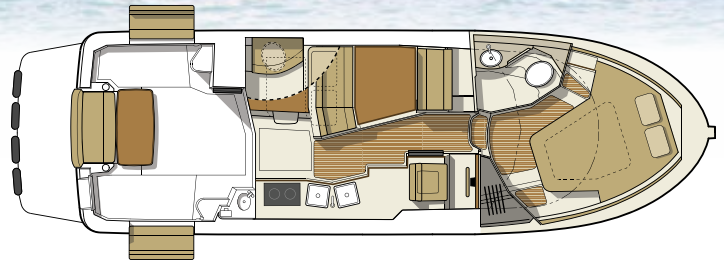

Specifications

Length Overall	31' 2"	9.5 m	Water Capacity	80 gals.	303 ltrs
Length w/swim step	35' 2"	10.7 m	Holding Tank Capacity	40 gals.	151 ltrs
Beam	10' 0"	3.05 m	Fuel Capacity (Main tank)	180 gals.	681 ltrs
Draft	28"	.71 m	Height on Trailer	13' 2"	4.03 m
Weight, Dry	10,500 lbs	4,763 kg			



Ranger Tugs 25802 Pacific Highway South Kent, Washington 98032
 Phone 253-839-5213 Fax 253-839-5218 www.rangertugs.com

Ranger Tugs R-31 Trailerable Command Bridge

Standard Equipment

Volvo 300 HP D4
Anchor locker, SS self launching bow roller through stem
Batteries (6) with charging relays, crossover
Battery charger, 50 amp
Bilge pump, (2) 12V automatic, 1000 gph
Bonded 12V electrical system with transom zinc
Cabin heater (engine)
CO monitor (2)
Cockpit convenience center, sink
Cockpit table and seating
Companion seat, double forward facing
Compass
Courtesy lights, cockpit entry step, side and bow
Cowl vent (ventilation in forward cabin)
Day head in midberth, electric flush
Dinette, salon, converts to bed, electric high/low table, sleeps 2
Electrical panels AC/DC
Enclosed head, sink, shower with enclosure
Engine, electronic controls with color display
Engine hatch, hydraulic lift
Entertainment ctr, master stateroom dvd, cd, 22" TV
Fiberglass cockpit liner, self bailing w/non-skid
Flybridge, retractable, compass, second station VHF, electronic controls, thruster control, trim tab control
Foredeck seat and table
Forward deck hatch, opening translucent
Hatches (5), pilothouse roof, opening with screens
Horns dual trumpet
Hot water tank, 11 gallon
Inverter 2500 watt Pro Mariner
Lounge seating, dinette converts to lounge for reading
Marine heads, fore and aft, electric, holding tank, deck pump out
Mast, stainless steel, hinged
Midship stateroom, double berth, desk and seat, privacy door, head
Navigation lights, with light boards
Outlets 110V (4)
Oven, electric, two burner cooktop, microwave
Pilothouse door, stbd side, sliding, locking
Portlights, brass, opening with hooks
Power outlet, 12V port and stbd, fwd state room, midship
Refrigerator, 12V DC
Refrigerator, cockpit 12V
Rod holders (2)
Rudder, bronze
Salon entertainment center, 19" overhead TV/DVD
Seawater strainers
Shorepower 30 amp/115V, w 50' cord
Single-lever engine control (electronic)
Sinks (4), water system w/demand pump, H and C
Solid surface galley countertop, Karadon
Sport rack
Spotlight, 6" remote control
Stereo, Fusion AM/FM / MP3
Storage lockers, cabin, w/teak louvered doors

Swim platform, fiberglass with 4 rung ladder and fenders
Wine cooler, 6 bottle
Teak and holly carpet in cockpit
Thrusters, bow and stern
Transom door
Trim tabs, hydraulic
VHF radio (Garmin 300) dual station
Visor/drip rails, fwd and side windows
Washdown system cockpit, raw water
Water tank level monitor (fresh)
Windlass 12V Lewmar 1000 SS (helm and bow controls)
Windshield wipers (4) pantographic

Available Factory Options

Aft bimini top with boot	\$3,280
Aft side-enclosures, clear Strato-glass (Aft bimini required)	\$4,260
Aft station steering with electronic controls	\$4,350
Air conditioning/ Rev Cycle heat 16,000 BTU salon 12,000 BTU master	\$7,650
Anchor package 22# anchor, 50' HT chain, 200' line	\$540
Autopilot, Garmin, dual station with remote	\$5,999
Batteries, AGM upgrade	\$960
Carpet runner, teak & holly interior	\$940
Diesel heater, Webasto forced air furnace	\$5,450
Factory Delivery Experience	\$2,500
Generator, Onan 5kw with Sound Shield	\$13,300
Ice maker, cockpit, in lieu of standard cockpit refer	\$450
International option 240V dockside	\$860
LED lights	\$400
Macerator discharge w/ Y-valve	\$480
Nav Pkg Garmin 7215 lower, 7212 upper, 4KW radar, GPS ant, Depth/ FF	\$13,997
Safety kit, fenders, lines, flares, fire ext, first aid kit, life jackets, boat hook	\$790
Solar panel, Kyocera 140 watt with control panel	\$1,200
Stove, propane, propane box with two tanks	\$1,500
Thruster wireless remote (Bow and stern)	\$759
Trolling valve, electronic	\$2,000
Transom platform rails with gate (swimstep)	\$790

R-31 Introductory price

\$279,937*

**Options, freight & taxes extra*

www.rangertugs.com

Prices, specifications, equipment & options may change without notice